

规格书

SPECIFICATION

产品名称 Description:	开合式电流互感器 Split-core current transformer
型号规格 Type Specification:	CMCT-KH-24C 100A/5A
产品料号 Part Number:	88.0518125
制定日期 Date:	2023-10-31
<p>如您试用我公司以上型号规格样品合格, 或者对本规格书内容无异议, 请在下栏牵制或盖章, 并盖章回传。感谢您的支持与配合, 我们将竭诚为您服务!</p> <p>※客户认可回签 (章):</p> <p>请贵司确认, 提出修改意见:</p>	

❖ 版本修订记录/Revision record:

版本号 Version	修订日期 Revision Dater	修订内容 Amendment	修订页码 Revision number
A/0		制定版	

❖ 适用范围/Applicable scope:

This specification is widely used in charging stations, microcomputer protection, distribution and monitoring, electricity meters, power quality analysis, and electrical equipment signal acquisition power devices. It can also be used in digital instruments such as power transmitters, telemetry and remote control data acquisition systems, relay protection, etc.

❖ 适用条件/Applicable conditions:

- ① Environmental temperature: $-20\text{ }^{\circ}\text{C}\sim 70\text{ }^{\circ}\text{C}$, relative humidity $\leq 85\%$;
- ② Sea level: not exceeding 1000m;
- ③ Atmospheric conditions: There are no gases, vapors, chemical deposits, dust, or other corrosive or explosive media that seriously affect the insulation of the transformer.

❖ 技术要求/Technical requirements:

Comply with GB 1208-2006 "Current Transformers" standard and JB/T 10665-2006 "Micro Current Transformers" standard.

❖ 结构要求/Structural requirements:

The appearance is atmospheric and beautiful, the structure is novel and unique, the volume is small and the weight is light, the insulation and isolation ability is strong, and it is moisture-proof, anti-corrosion, and shockproof.

❖ 外型图/Physical dimension:

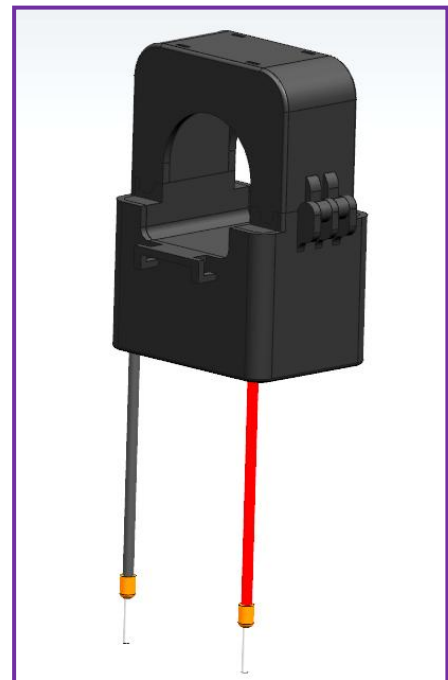
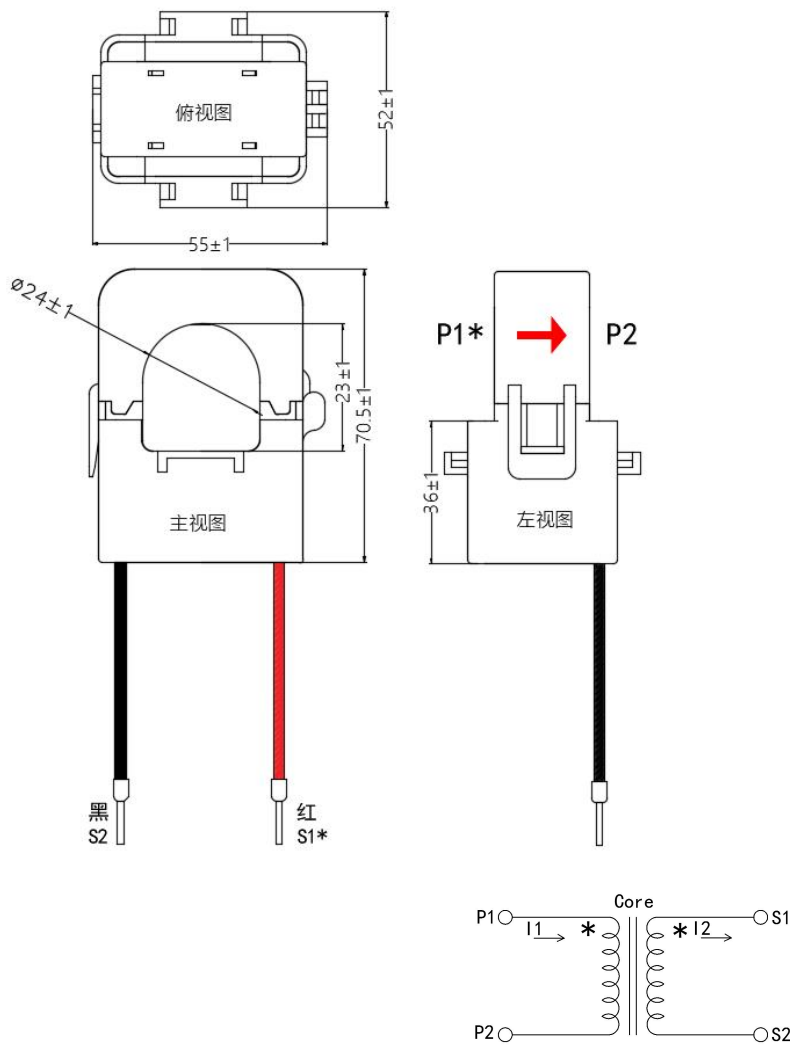

P1	Wire through the center into the end IN*
P2	Wire through the center into the end IN
S1	Secondary output terminal OUT*
S2	Secondary output terminal OUT*
*	Dotted terminal

❖ 电气参数/Electrical parameters(Ta=25°C±5):

参数 Parameter	符号 Symbol	范围 Range	单位 Unit
额定输入电流 Rated input current	IPN	100	A
测量电流范围 Measuring current ranges	IP	5~120	A
二次输出 Secondary output	IO	5	A
精度 Accurate	X	0.5	级
相位差 Phase difference	δ	≤ 120	分
耐压 voltage withstand	VD	50Hz@rms/1min/ > 2.5	KV
工作频率 Operating Frequency	f	50/60	HZ
绝缘电阻 Insulation Resistance	VDR	DC500V/1min/ > 500	M Ω

❖ 测试误差/Test error(Ta=25°C±5):

电流误差 (比差) ±% Current error ±%				相位误差 (角差) ±分 Phase error ±'			
额定电流 Rated current				额定电流 Rated current			
5A	50A	100A	I _{max}	5A	50A	100A	I _{max}
$\leq \pm 0.75$	$\leq \pm 0.5$	$\leq \pm 0.5$	$\leq \pm 0.2$	$\leq \pm 120$	$\leq \pm 100$	$\leq \pm 90$	$\leq \pm 60$

❖ 机械参数/Mechanical parameters:

外壳材质 Shell material	ABS 阻燃等级 94-V0 ABS flame retardant grade 94-V	外壳颜色 Shell color	黑色 Black
一次输入方式 An input mode	电缆穿心式输入 Cable through core input	铁芯 Magnetic core	硅钢片 Silicon Steel
二次输出方式 Two output mode	1.5 平方/红-黑线 长 2.0 米 1.5 square meters per red black line with a length of 2.0 meters	漆包线 Enameled wire	QA-1.2mm - 155
介质填充料 Medium filling material	/	质重 Weight	$\leq 220g$